

GENERAL NOTES: ELEVATIONS

- REFER TO SA500 - SA508 FOR EXTERIOR WALL ASSEMBLIES.
- GO TO PROVIDE GFRC PANEL LAYOUT IN SHOP DRAWINGS BEFORE CONSTRUCTION TO ARCHITECT FOR REVIEW.
- CLOSURE PLATES SHALL BE INSTALLED AT TOP & BOTTOM OF ALL VERTICAL MULLIONS PRIOR TO INSTALLATION OF GLAZING UNITS.
- MULLION FACE CAP (AS APPLICABLE) TO BE 1" FROM FACE OF CAP TO FACE OF GLASS.
- DO NOT INSTALL GLAZING UNITS IF PERIMETER JOINTS TO ADJACENT MATERIAL ARE LESS THAN 1/2" OR MORE THAN 1", TYPICAL.
- GO TO PROVIDE SIGNED AND SEALED SHOP DRAWINGS FOR CURTAIN WALL AND STOREFRONT. ARCHITECT TO REVIEW LAYOUT. ENGINEER TO REVIEW STRUCTURAL LOADS.
- PROVIDE BOND BREAKER TAPE AT ALL T & F CLIPS, TYPICAL.
- ALL EXPOSED STEEL ON BUILDING EXTERIOR TO BE FACTORY PRIMED AND PAINTED. STRUCTURAL AESS 3 FINISH. HIGH PERFORMANCE PAINT/COATING.
- ALL EXPOSED MISC. METAL CLOSURE ANGLES, ETC. ON BUILDING EXTERIOR TO BE PREFINISHED TO MATCH STOREFRONT / WINDOW FRAMES ETC. U.N.O. BY ARCHITECT.

GENERAL NOTES: STOREFRONT AND CURTAIN WALLS

- ALL EXTERIOR GLAZING INCLUDING FRAMES TO MEET HURRICANE RESISTANCE. GO TO PROVIDE CERTIFIED REPORT ACCEPTABLE BY LOCAL AHJ TO MEET BOTH REQUIREMENTS. PROVIDE CUSTOM ANODIZED ALUM. FINISH COLOR. STOREFRONT MULLIONS AND END CAPS (AT BOTH INTERIOR AND EXTERIOR) - TYP. PROVIDE BALLISTIC LEVEL 7 RATED GLASS AT FIRST FLOOR LOBBY, ENTRY VESTIBULE, AND SECURITY OFFICE. REFER TO EXTERIOR ELEVATIONS FOR LOCATIONS OF INTEGRATED HORIZONTAL LOUVERS.
- TEMPERED GLAZING REQUIREMENTS:** ALL SPANDREL ZONES WITHIN 25'-0" ABOVE GRADE SHALL BE TEMPERED, U.N.O. ALL INTERIOR LITES SHALL BE TEMPERED, U.N.O. ALL GLAZING IN DOORS AND WITHIN 24" OF A DOOR SHALL BE TEMPERED, U.N.O. ALL LITES THAT ARE MORE THAN 9 SQ. FT. IN SURFACE AREA SHALL BE TEMPERED, U.N.O. ALL LITES WITHIN 18" OF THE FLOOR SHALL BE TEMPERED, U.N.O. ALL LITES THAT ARE WITHIN 36" OF A WALKING SURFACE SHALL BE TEMPERED, U.N.O. ALL EXTERIOR LITES WITHIN 25'-0" ABOVE GRADE, INCLUDING THOSE WITHIN 24" OF DOOR OPENINGS, SHALL BE TEMPERED, U.N.O.

ELEVATION KEYNOTES

AF3	FORTON MODIFIED GYPSUM CLADDING PANELS. FINISH: CUSTOM TEXTURE. COLOR: TO MATCH BENJAMIN MOORE 2134-60 SIDEWALK GRAY
AF6b	ARCHITECTURAL ALUMINUM METAL PANELS. COLOR: TO MATCH ALUCOBOND WHITE
AF8a	IMPACT RESISTANT ANODIZED ALUMINUM STOREFRONT C/W DOUBLE SEALED GLAZING UNITS. MULLION COLOR: CLEAR
AF9a	IMPACT RESISTANT ALUMINUM CURTAIN WALL C/W DOUBLE SEALED GLAZING UNITS. MULLION COLOR: CLEAR
AF9b	IMPACT RESISTANT ALUMINUM CURTAIN WALL C/W INSULATED SEALED GLAZING SPANDREL & FINISHED BACK PAN SPANDREL. COLOR: TO MATCH BENJAMIN MOORE "CHEATING HEAT 1617"
AF9c	BALLISTIC RESISTANT ALUMINUM CURTAIN WALL C/W DOUBLE SEALED GLAZING UNITS. MULLION COLOR: CLEAR
AF10	ARCHITECTURAL HORIZONTAL LOUVER SCREEN. COLOR: TO MATCH ALUCOBOND RUSTIC WALNUT
AF11	IMPACT RESISTANT GLASS GUARDRAIL
AF14	COILING OVERHEAD DOOR. COLOR: MATCH ALUCOBOND WHITE
AF17	INSULATED METAL SWING DOOR. COLOR OF DOORS AND FRAMES: TO MATCH ADJACENT WALL. FINISH COLOR: CLEAR
AF23	DOWNSPOUT CONNECTED TO STORM DRAINS - TYP. COLOR: TO MATCH ALUCOBOND WHITE
AF24	OVERFLOW SCUPPERS LOCATED 4" ABOVE THE LOW POINT OF THE ASSOCIATED ROOF SECTION. COLOR: TO MATCH ADJACENT FINISH MATERIAL
AF25	COLLECTION BOXES CONNECTED TO DOWNSPOUTS. COLOR: TO MATCH ASSOCIATED DOWNSPOUT

CLIENT

1 N University Dr, Plantation, FL, 33324

COPYRIGHT

This drawing has been prepared solely for the intended use. Thus any reproduction or distribution for any purpose other than authorized by Arcadis is forbidden. Written dimensions shall have precedence over scaled dimensions. Contractors shall verify and be responsible for all dimensions and conditions on the job, and Arcadis shall be informed of any variations from the dimensions and conditions shown on the drawing. Shop drawings shall be submitted to Arcadis for general conformance before proceeding with fabrication.

Arcadis Inc.

ISSUES

No.	DESCRIPTION	DATE
A	ISSUED FOR SPA - MOD	2025-11-12

SITE KEY PLAN

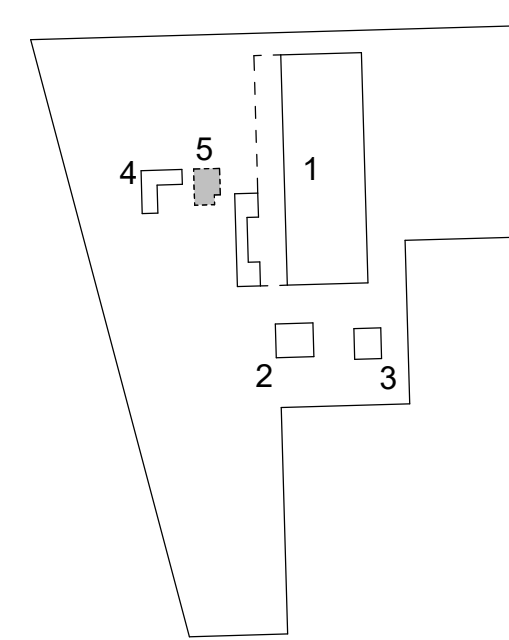

CONSULTANTS

ARCHITECT: ARCADIS ARCADIS INC. 7000 N. FEDERAL HWY. - 2ND FLOOR BOCA RATON, FL 33487 (561) 998-8000 contact: JAY KELLY email: jay.kelly@arcadis.com	CIVIL ENGINEER: ARCADIS ARCADIS INC. 7000 N. FEDERAL HWY. - 2ND FLOOR BOCA RATON, FL 33487 (561) 998-8000 contact: PATRICIA RAMALHO email: patricia.ramalho@arcadis.com
LANDSCAPE ARCHITECT: ARCADIS ARCADIS INC. 21 CUSTOM HOUSE ST. - 3RD FLOOR BOSTON, MA 02110 (617) 898-2000 contact: PHIL COLLIERAN email: phil.collieran@arcadis.com	SITE ELECTRICAL: ARCADIS ARCADIS INC. 451 FANNETTVILLE STREET SUITE 100 HAVERHILL, MA 01830 (978) 861-4211 contact: KEVIN SCHAEFER email: kevin.schaefer@arcadis.com
STRUCTURAL ENGINEER FOR BUILDINGS: JEZERINAC JEZERINAC GROUP 1915 FORUM FL WEST PALM BEACH, FL 33411 (561) 323-7223 contact: BILLY RAOULA email: billy.raoula@jezgroup.com	STRUCTURAL ENGINEER FOR BRIDGES: LANCASHIRE ENGINEERING, INC. LANCASHIRE ENGINEERING, INC. 2211 NE 45TH STREET FORT LAUDERDALE, FL 33308 (954) 771-0000 CONTACT: LANCASH NAWANAKKARA EMAIL: LYES@LANCASHIREENGINEERING.COM
MEPP: SEC South Engineering Consultants, Inc. SMITH ENGINEERING CONSULTANTS 2161 PALM BEACH LAKES BLVD SUITE 101 WEST PALM BEACH, FL 33411 (561) 646-3011 contact: STEVE P. HOCKMAN email: steve@smithengineeringconsultants.com	

SEAL

PRIME CONSULTANT

Suite 307A - 1451 W. Cypress Creek Road
Fort Lauderdale FL 33309 USA
tel 249 936 8000
www.arcadis.com

PROJECT

THE TRAINING AND COMMAND
CENTER BUILDING
3201 W Copans Road
Pompano Beach, FL

PROJECT NO:

136677

DRAWN BY:

ARCADIS

PROJECT MGR:

PR/AS

CHECKED BY:

ARCADIS

APPROVED BY:

DF/JK

SHEET TITLE

BUILDING ELEVATIONS

SHEET NUMBER

5A201

ISSUE

A